

TAVIA



TH
ANNIVERSARY

2024
catalogue

TRANSFORMATION

TAYA stays ahead of market trends and continually improves our products to proceed competitively and adaptably.

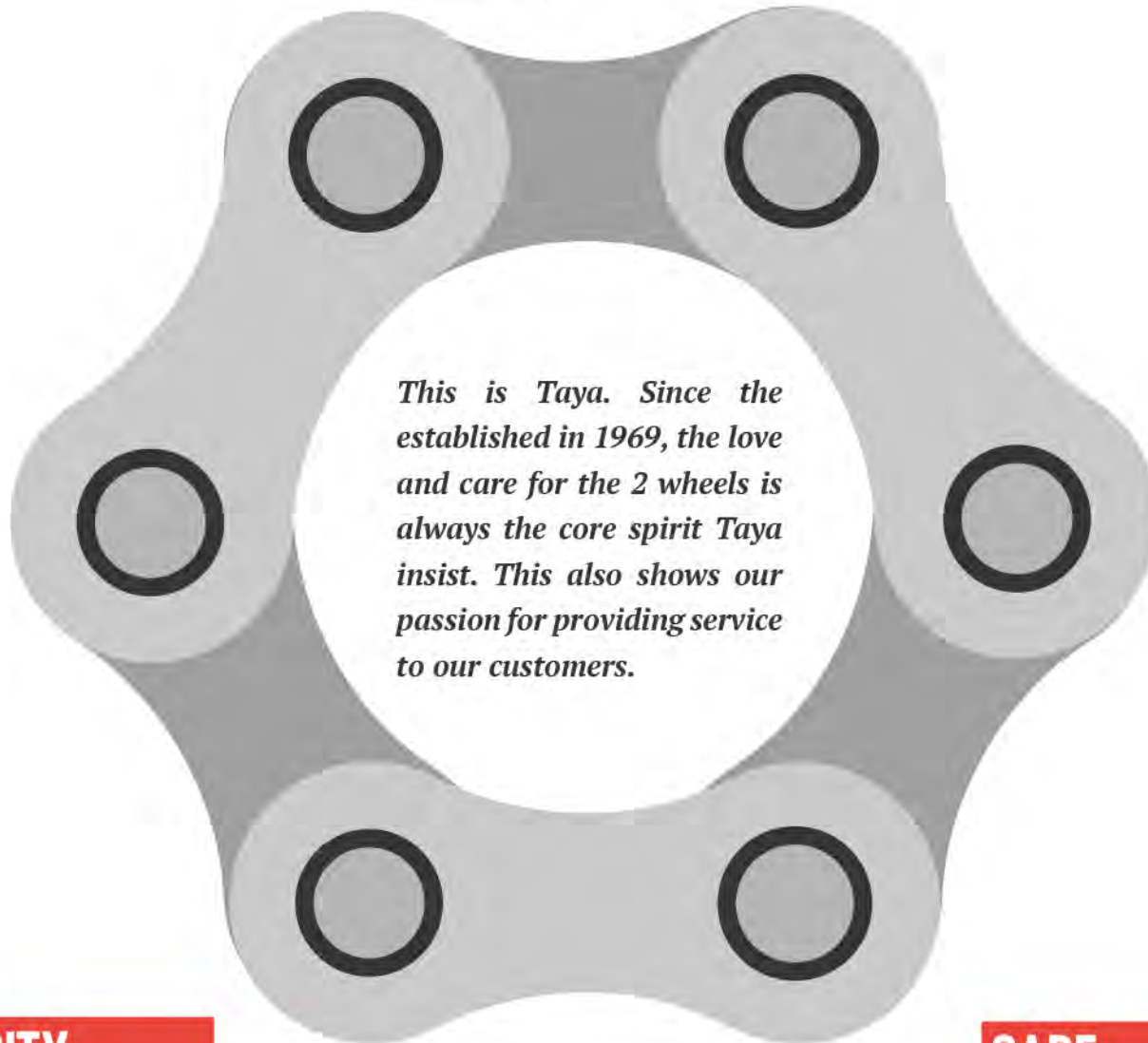

This is Taya. Since the established in 1969, the love and care for the 2 wheels is always the core spirit Taya insist. This also shows our passion for providing service to our customers.

SIMPLICITY

TAYA strives to simplify the way riders find the best chain for their needs.

CARE

Every perfect machine has a big heart making it work.

Our aim is to be the best, fastest, and easiest choice for customers. This is reflected in every aspect of our product development, from the rollerless design to the efficiency of our production chain, and the pre- and post-sales support we provide. Our new slogan **“Simplify Your Ride”** symbolizes our mission to make it easier for customers to find the best solutions for their two-wheeled vehicles.

TAYDA

TAYA history

TAYA Chain is a historic chain manufacturer based in Taiwan and is going to celebrate its 55th anniversary in 2024. With the leading technology and environmental awareness, TAYA's chains are available worldwide. Additionally, TAYA continues to enhance products to ensure customer satisfaction. Over the years, TAYA has obtained nearly 100 product patents and received 10 global innovation awards. Our primary objective is to deliver innovative and user-friendly designs, and we are always striving to achieve this goal.

1969

WORLD'S LEADING CHAIN MAKER

TAYA Chain Co., Ltd. Established that inherited the technology from Japan-Tsubaki Chain Co. starting producing bicycle/motorcycle/industrial chains.

1975

PRODUCT EXPANSION

Product range was expanded to #410 #408 #420 #425. Annual production achieved 350,000pcs

1990

NARROW CHAIN

Creations with patents for bicycle chain, including the narrow chain for multiple derailleur systems

1995

ISO-9002

ISO-9002 quality system had been approved by Ministry of Economic Affairs.

2000

ISO-9001

* Headquarter set up at current place.
* ISO-9001 quality system approved (BVQI).

1984

ALTERNATION OF GENERATIONS

The 2nd generation of the family succeeded the business. Annual capacity huge expanded 6.5 times to 2.6 million pcs.

1993

SIGMA CONNECTOR

The world's 1st No-Tool required patented Sigma Connector developed.

1999

1ST CHAIN AUTO- PRODUCTION SYSTEM

Global 1st chain auto-production system called TCPS conducting the automatic chain production line under standard, module, and system design

2002

9/10 SPEED ROLLERLESS CHAIN

Top 9/10 speed bicycle chains, and rollerless chain were developed.

2007

"DECA" 10-SPEED CHAIN

* TAYA plating factory been certified by USA MacDermid with No Cr+6 production process.
* New series of inclined bridge 10-speed chain, "DECA" was released.

2013

MOTORCYCLE CHAINS REBOOTED

2010

IF AWARD

* CQI-11 Plating System Assessment certified by GM.
* Won the iF Design Eurobike Award.

2016

E-BIKE CHAIN

E-Bike chain, withstand in 1000W electric central motor & 160Nm torque output.

2018

GALAXY CHAINS & SIGMA +

Amazing new Galaxy chains, and Sigma + connectors announced

2020

ROLLERLESS SERIES

Developed three-component chains - Rollerless Series. This ground-breaking innovation reduces chain weight and minimizes material usage, making it more eco-friendly.

2023

NEW BRAND-ZENAS

A new brand, ZENAS is born, with a focus on producing heavy duty drivetrain system parts, particularly for E-Cargo bikes equipped with internal gear hubs

2024

TAYA'S
55TH
ANNIVERSARY

HALL OF FAME

A concert scene with purple spotlights and a crowd. The text "HALL OF FAME" is centered in white. The background shows a stage with bright lights and a crowd of people in the foreground, some holding up phones or cameras. The overall atmosphere is vibrant and energetic.



GOLDEN PIN AWARD

2010 - 10S DECA-101 Ti-Gold Packaging Box

EUROBIKE AWARD

2010 - Rustproof eco-chain 1S Super Single-a

IF DESIGN AWARD

2010 - TAYA GST Halflink Chain

CHINA CYCLE AWARD

2012 - 10S DECA-101(UL)
2013 - Traveler Series Color chain
2014 - 8S e OCTO-DH GST
2015 Gold - Aero Lightweight Bicycle Chain 10S EVO-Light 101

TAIWAN EXCELLENCE AWARD

2011 - Rustproof eco-chain 1S Super Single-a
2012 - Diamond Hard Chain 10S Deca-101(UL)
2015 - Lightweight Triathlon Bike Chain 10S EVO-Light 101
2017 - E Bike Chain 11S e ONZE-111
2021 - 12Speed Roller-Less Chain 12S EL-TOLV-127

TAIPEI CYCLE AWARD D&I AWARDS

2021 - Rollerless Chain 12S EL-TOLV-121 Galaxy
2022 - E Bike Chain 12S e TOLV-121 30meter box

MIT MADE IN TAIWAN

RIDE WITH TAYA

SPONSORED TEAMS AND RIDERS ARE IMPORTANT TO TAYA.

TAYA is proud to supply chains to cycling teams who share our passion for cycling. By working closely with professional cyclists, we receive valuable feedback to improve and produce the highest quality chains. Supporting sponsored teams also helps to promote the TAYA brand worldwide. Athlete sponsorship is a crucial part of TAYA's promotional efforts, as it provides opportunities for valuable product testing and helps to drive our R&D program. This year, we are proud to sponsor the following sports marketing assets.



France-Team Challenge One

Chain Model: e-TOLV-121/TOLV-121



Italy-KTM Alchemist Team

Chain Model: TOLV-121



France-Lapierre Mavic team

Chain Model: e-TOLV-121/TOLV-121



Italy-360 valtellina

Chain Model: e-TOLV-121/TOLV-121



UK-RR23 Team

Chain Model: ONZE-111/TOLV-121



Slovenia-Ljubljana Gusto Santic Team

Chain Model: TOLV-121



France-Team Ornans Superior

Chain Model: TOLV-121



Romania - Mentorise Elite Team

Chain Model: ONZE-111



Spain-Torres - Fernando Barceló Team

Chain Model: ONZE-111/TOLV-121



Sweden - Nordic Sports Academy

Chain Model: ONZE-111/TOLV-121



Taiwan-CCN SHINING TEAM

Chain Model: ONZE-111



Spain-David Cachon

Chain Model: TOLV-121



Italy-Bruno Ferraro

Chain Model: ONZE-111



SIMPLIFY
your ride.

Tech

12	DHT
14	GST
16	SEC
22	SIGMA+ CONNECTOR

Chains

18	E-BIKE
24	ROLLER-LESS
26	GALAXY
28	MULTICOLOR CHAIN
30	11S-9S ROAD BIKE CHAIN
32	12S-8S OFFROAD BIKE CHAIN
38	1 S INTERNAL GEAR HUB
40	1S BMX, FIXIE AND EXERCIZE BIKE

Utility

42	COMPATIBLE CHART
45	PACKS



ICONS

MATERIALS



TEFLON COATING:
TEFLON COATED WITH JOYFUL COLORS & SELF-LUBRICATION FEATURE.



COLORFUL CHAIN:
PLATES COATED WITH DIVERSIFY COLORS.



GALAXY SERIES:
MIRRORING AND COLORFUL SURFACE WITH EASY RINSE FEATURE.



DHT TREATMENT:
TAYA EXCLUSIVE TECH WITH SELF-LUBRICANT AND EXTREME DURABILITY.



GST TREATMENT:
TAYA EXCLUSIVE GREEN TREATMENT TO ENHANCE RUST- PROOF.



SEC TREATMENT:
TAYA EXCLUSIVE SELF LUBRICATING ECO-FRIENDLY COATING

FUNCTION



DEVELOPED FOR E-BIKE
BEST CHOICE FOR MOTOR-ASSISTANT BICYCLE.



EVO-LIGHT SERIES
PERFECT BALANCE BETWEEN EXTREME WEIGHT SAVING & SAFETY.



LIGHT WEIGHT DESIGN
ACHIEVE REMARKABLE WEIGHT-REDUCTION BY 100% HOLLOW PARTS.



HIGH TENSION STRENGTH
MEET THE DEMAND FROM EXTREME RIDERS .



MUD AND WATER SHED OFF
HOLES ON PLATES WHICH CAN SHED OFF DIRTY EASILY.



SILENT DESIGN



SELF-LUBRICATION



SUPER DHT TREATMENT:
SLOWS DOWN CHAIN ELONGATION ON E-BIKE, CHAIN LIFE IS GREATLY PROLONGED.

*This icon is for ebike chain series with dht treatment

CONSTRUCTION



ENLARGED OUTER PLATE

UTMOST OUTER PLATS SUPPORT CHAIN SITTING IN POSITION ON BUMPING ROAD.



OUTER CHAMFERED OUTER PLATES

GREAT SLICK & QUIET SHIFTING PERFORMANCE.



INNER CHAMFERED PLATE

ESSENTIAL SMOOTH SHIFTING DESIGN.



SUPER LENGTH INNER CHAMFER

IDEAL SMOOTH SHIFTING PROPERTY DESIGNED ALONG WITH CHAIN MOVING LINE.



INCLINED BRIDGE

UNIQUE DESIGN FOR UTMOSTLY EARLY COG CLIMBING.



STRAIGHT BRIDGE

HELPS CHAIN CLIMBING UP BIGGER COGS IN TRANSMISSION.



3 TIMES DURABILITY



RUST PROOF TREATMENT



SUB PUNCHED PIN

360° RIVETING PROVIDES FULLY STRENGTH.



HOLLOW PIN

EYE-CATCHING AND WEIGHT REDUCTION DESIGN.



HALF-LINK

MEET FLEXIBLE DEMANDS IN ODD/EVEN LINKS.



ASYMMETRIC SHAPE IN WAIST

CURVED SIDE PLATE DESIGN TO COMPLETELY STAY ON CHAINRING.



ROLLER-LESS



DEEP DISH CHAMFERED & BULGED OUTER PLATES



LOW EMISSION PRODUCTION



SCRATCH RESISTANT SURFACE



TAYA KNOWS.

TAYA's exclusive DHT technology provides the best solution to do these.

DHT FEATURES:

125% HARDER: Surface hardness improved by up to 125%

LEAKED-IN HARDENING:

Because the hardening substance is "leaked-in". It doesn't add weight or thickness to the chain, and the shifting is still smooth.

MINIMIZED WEAR:

Minimizing chain wear protects the whole drivetrain and prolong the chain life.

DHT TREATMENT BOOSTS CHAIN DURABILITY BY PROTECTING AGAINST HIGH TORQUE, EXTENDING AVERAGE LIFESPAN TO OVER 8,000 KM.

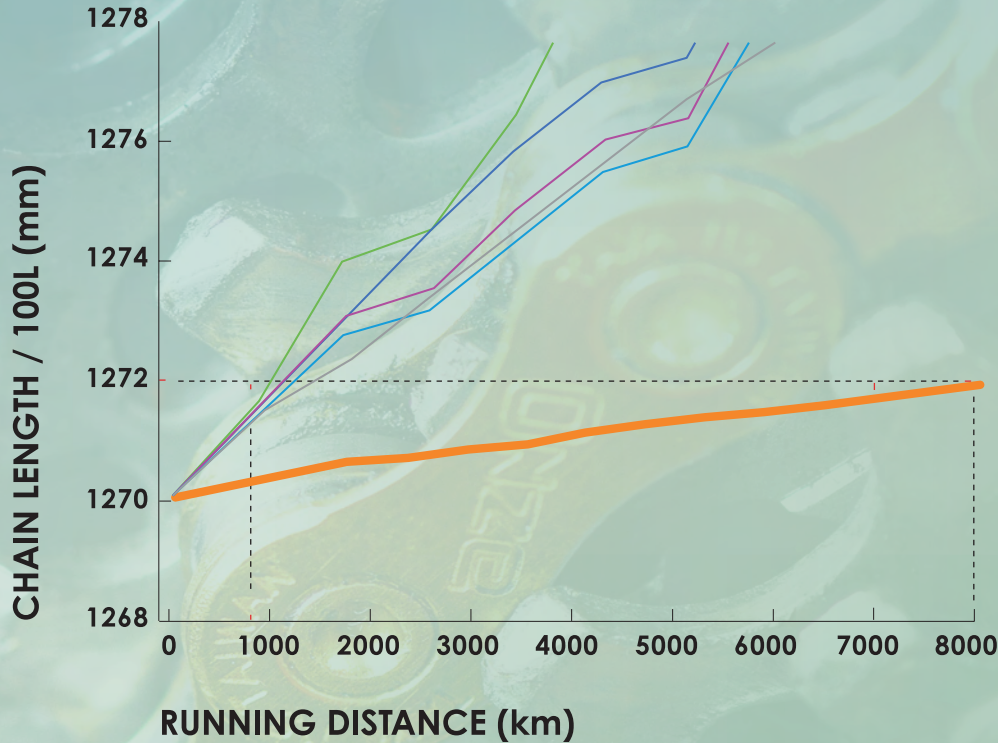

Compare with leading brands:

S1-11S Road chain

K1-11S E-Bike chain

S2-11s MTB chain

S2-10S chain

S1-12S MTB chain

Taya DHT chain

HARDNESS TREATMENT

OTHER BRANDS

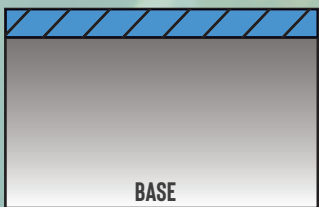

PROTECTION LAYER
0.015 mm Depth

HARDNESS:
≤1500 HV

TAYA

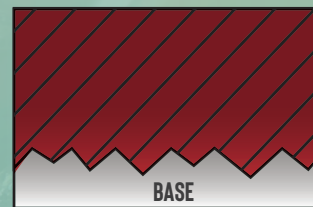

PROTECTION LAYER
0.050 mm Depth

HARDNESS:
1500~2000 HV



**ANTI-RUST &
ECO-FRIENDLY.**

RUST PREVENTION IS ESSENTIAL! WATER, HIGH HUMIDITY, MIST AND SALT ARE FACTORS OF IMPACTING CHAIN PERFORMANCE.

FEATURES:



100% Rust-proof from pin to plates



Scratch resistant



Easy maintenance



Eco-friendly plating, non toxic coating

COMPREHENSIVE CORROSION PROTECTIONS.

- OUR ANTI-RUST PERFORMANCE IS TWICE AS GOOD AS STAINLESS STEEL.
- UNLIKE ZINC-FLAKE COATED ANTI-RUST TREATMENT, GST IS A SPECIAL IN-HOUSE ELECTROPLATING WHICH LEAVES 1/3 OF THE THICKNESS.
- GST ANTI-RUST CHAIN COMPONENTS MAKE CLEANING EASIER WHILE RINSING OFF DIRT AND MUD. TAYA-GST HAS PASSED OVER 1,000 HOURS OF SALT SPRAY TEST WITH RESULTS SHOWING
- UP TO 25 YEARS OF RUST RESISTANCE!
- 100% FREE OF HEXAVALENT CHROMIUM COMPOUNDS AND MEET ROHS, REACH, AND CPSIA STANDARDS.
- TAYA'S EXCLUSIVE SURFACE TREATMENT CAN BE APPLIED TO ALL THE BICYCLE FASTENERS.



**SELF-LUBRICATING
ECO-FRIENDLY
COATING**

A close-up, low-angle shot of a bicycle chain and gears. The chain is the central focus, stretching horizontally across the frame. The background is dark and out of focus, showing the intricate mechanical parts of the bike's drivetrain. The lighting is dramatic, highlighting the metallic surfaces of the chain links and the teeth of the gears.

SEC, ALSO KNOWN AS “SELF-LUBRICATING ECO-FRIENDLY COATING”, IS A GAME-CHANGER IN THE WORLD OF BIKE CHAIN LUBRICATION.

UNLIKE TRADITIONAL BIKE CHAIN OIL, WHICH CAN BE TOXIC AND MESSY, SEC IS COMPLETELY TOXIC-FREE AND ELIMINATES THE NEED FOR CONSTANT RE-LUBRICATION. THE SELF-LUBRICATING PROPERTIES OF SEC PROVIDE THE SAME LEVEL OF PERFORMANCE AS TRADITIONAL OIL WITHOUT THE NEED FOR FREQUENT APPLICATIONS, MAKING IT A **MORE EFFICIENT AND ECO-FRIENDLY OPTION.** ADDITIONALLY, SEC KEEPS HANDS CLEAN DURING CHAIN REPLACEMENT, AS TRADITIONAL LUBRICANTS CAN LEAVE HANDS DIRTY AND GREASY. OVERALL, SEC IS AN INNOVATIVE SOLUTION THAT COMBINES PERFORMANCE, EFFICIENCY, AND SUSTAINABILITY FOR A BETTER CYCLING EXPERIENCE.



E-BIKE CHAIN SERIES

E-bikes are becoming increasingly popular for various purposes, including commuting, trekking, and carrying large items, especially in Europe and North America. TAYA has developed E-bike chains with enhanced impact resistance, ranging from 12-speed chains to the IGH system. In field tests, the chains have proven to be compatible with Bosch series (350W, 85Nm) and Yamaha series (500W, 85Nm) without any issues. TAYA's super DHT technology ensures a hardness level of HK 2,000, making TAYA's E-bike chains capable of withstanding high torque outputs from mid-drive drivetrains. As a result, TAYA's E-bike chains are approved for 1000W and 160Nm torque mid-drive systems, making them highly recommended for sporty pedelecs.



MORE INFO

DURABLE E-BIKE CHAINS FOR MID-DRIVE SYSTEMS: TAYA'S ENHANCED IMPACT RESISTANCE TECHNOLOGY

COLORS:



Gst-500



Silver/Silver

HIGH TORQUE & IMPACT RESISTANCE



Impact obstruction



High-Torque Resistance



Wear Prevention



EASY MAINTAIN DHT
self-lubricant

e TOLV-121

Sigma⁺

Connector Included

Compatibility:

12-Speed,

1/2" x 5/64"



12 Speed



Silver/Silver



Dht Treatment



Inner Chamfered Plate



Outer Chamfered Outer Plates



Super Length Inner Chamfer



Developed for E-Bike



Sub Punched Pin

e ONZE-111

Sigma⁺

Connector Included

Compatibility:

11-Speed,

1/2" x 5/64"



11 Speed



TAIWAN
EXCELLENCE
2017



Silver/Silver



Dht Treatment



Inner Chamfered Plate



Outer Chamfered Outer Plates



Super Length Inner Chamfer



Developed for E-Bike



Sub Punched Pin

e DECA-101

Sigma⁺

Connector Included

Compatibility:

10-Speed,

1/2" x 5/64"



Silver/Silver



Dht Treatment



Inner Chamfered Plate



Outer Chamfered Outer Plates



Super Length Inner Chamfer



Developed for E-Bike



Sub Punched Pin

e NOVE-91

Sigma⁺

Connector Included

Compatibility:

9-Speed,

1/2" x 5/64"



Silver/Silver



Dht Treatment



Inner Chamfered Plate



Outer Chamfered Outer Plates



Super Length Inner Chamfer



Developed for E-Bike



Sub Punched Pin

e OCTO-DH

Sigma⁺

Connector Included

Compatibility:

8/7-Speed,

1/2" x 3/32"



8 Speed



Silver/Silver



Dht Treatment



Inner Chamfered Plate



Outer Chamfered Outer Plates



Super Length Inner Chamfer



Developed for E-Bike



Sub Punched Pin

e TB-910 DH (1/8")

e TB-980 DH (3/32")

Sigma⁺

Connector Included

Compatibility:

1-Speed,

1/2" x 1/8"

1/2" x 3/32"

1 Speed



Silver/Silver



Dht Treatment



Inner Chamfered Plate



Outer Chamfered Outer Plates



Super Length Inner Chamfer



Developed for E-Bike



Sub Punched Pin

SIGMA⁺ CONNECTOR

TAYA'S FLAGSHIP OF CONNECTORS

The Sigma+ is TAYA's flagship connector that has been continuously developed since the 1990s. Designed to simplify the tasks associated with quick and reliable bicycle chain mounting, the Sigma+ is easy to use and a great tool for all cyclists. This innovative connector greatly reduces the time and effort needed for chain mounting, and its reusable design makes it an eco-friendly option for riders.

SPECIFICATIONS

- Available for 8 - 12 speed chains
- Unique stopping latch design prevents the link coming loose
- Quiet shifting experience from smooth plate design
- DHT pin equipped to be self-lubricating, and as durable as other DHT chain link
- Compatible for all brands of chain in the market



QUICK INSERT AND PULL



EASY MAINTAIN
(DHT SELF-LUBRICANT PARTS)

LOCKING

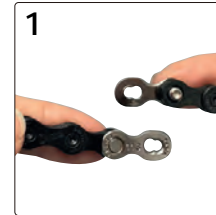

Insert both halves of Sigma Connector into both ends of chain

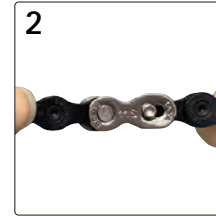

Buckle both halves of Sigma Connector together

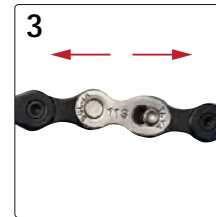

Pull the chain with the tool

UNLOCKING

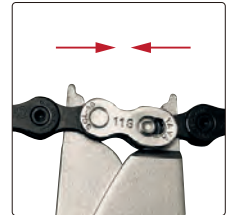

Remove Sigma Connector by tool

4. PIONEER T-PIN:

Broadened flat head fully covers pin hole & supports enhanced riveting strength against side force

5. EASY PULL OUTWARD:

Just pull less than a second!

6. OPTIMUM INTERVAL:

Precisely engineered distance to ensure silky and stable sit per riding even in bumps

7. TAYA DHT PIN:

TAYA exclusive DHT tech creates unbelievable durability and great shifting strongest and consistent hardness for entire parts to guarantee anti-elongation

SIGMA^{PRO} CONNECTOR

28-YEAR UNI-TECH

For 28 years, the Sigma Pro Connector has been TAYA's reliable solution for fast and easy chain assembly without requiring a chain removal tool. Its pinhead groove interlocks with the top plate to provide the same strength as any other link in the chain, without sacrificing shifting quality. Millions of cyclists around the world use Sigma Pro connectors every day, and their continued popularity is a testament to their outstanding reliability.

SPECIFICATIONS

- Available for 1-speed up to 7-speed chains
- Riveting strength min. over 250kgf
- Quiet shifting performance from the smooth plate design
- DHT pin equipped to be self-lubricating, and as durable as other DHT chain links
- Compatible with all chain brands in the market



SAFE



TOOL-FREE UNLOCKING
(FREE-TYPE SIGMA PRO)



MAGIC SWITCH TAYA'S EXCLUSIVE WAY
TO REPLACE AN OLD CHAIN ON A BIKE

LOCKING

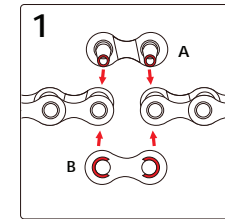

A. Sigma Pro link
B. Sigma Pro top plate

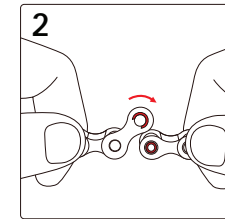

Push and hold Sigma Pro top plate, pass open Sigma Pro link through the end of the chain

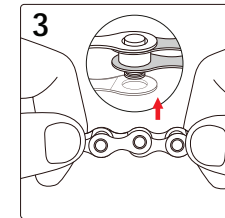

Place the Sigma top plate over the top of the free rivet groove while gently bending the Sigma link

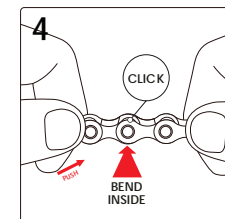

Press down Sigma top plate until you hear a "click", the chain is correctly assembled

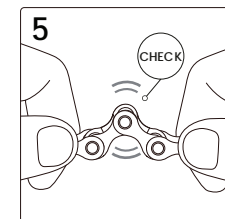

Check all of the chain to ensure no stiff links

UNLOCKING

Open a chain by bending it hardly with the top plate of Sigma Pro connector toward yourselves until the top plate jumps out. For safety, one-time use for Sigma Pro connector.



GALAXY

TAYA's Galaxy series defies the typical image of a bike chain that has dominated the industry for years. With precise control in just a few milliseconds, TAYA brings the beautiful colors of the Milky Way to your bicycle with their new Aurora Green, Galaxy Purple, and Blue finish.

- Superior scratch resistance
- Outstanding Long-lasting color
- Multi-color option to fit your own taste
- Available on 10 to 12 speed chains

Designed for high efficiency and durability, TAYA's galaxy chain series is the result of meticulous engineering and real-world testing that guarantees its strength. The chain is equipped with intelligent features that ensure smooth shifting and continuous performance, even under the toughest riding conditions.



GALAXY PURPLE RED



GALAXY GREEN



GALAXY BLUE

RIDE WITH JOY AND STYLE: A CHAIN OF MULTIPLE COLORS

TAYA's patented Sigma Quick Link OEM Type provides a unique advantage of 100% full color coverage on all chain links, without any non-colored links or visible scratch marks on the chain connecting pin. With the easily assembled Sigma Quick Link, you can create an entirely unique, eye-catching, colorful chain. TAYA offers three different ROHS and CPSIA compliant colorful chain series, allowing you to choose from multiple colors or create your custom colors. Express your individuality and stand out from the crowd with TAYA's colorful chains.



LOHAS SERIES

TEFLON COATED

Features:

- Anti-Corrosion features
- Self-lubricating, only minimum lubrication needed
- Teflon coated material with 100% RoHS / REACH compliant
- Recommended for bike with internal gear hub, fixie bike, BMX

Recommended for TAYA models:

410H / 408H / TB-910 / TB-980 / Super Single-α

Sigma connector included



WHITE



BLACK



SILVER



PURPLE



RED



BRIGHT
RED



ORANGE



SUNNY
YELLOW



GREEN
YELLOW



BASIL
GREEN



CELESTE



WATER
BLUE



ROYAL
BLUE





11S-9S ROAD BIKE CHAIN

Ultra-light chains, UL edition, are one of TAYA's top performance chains that meet the needs of all extraordinary road bike riders. These chains are much lighter and 100% compatible with different systems. Moreover, while applying DHT (Diamond Hard Technology), the shifting is extremely smooth and accurate every single time.

RECOMMENDED FOR 11-9 SPEED ROAD BIKES.



MORE INFO

ONZE-111 (UL)

Sigma⁺

Connector Included

Compatibility:

11-Speed,
1/2" x 5/64"

11 Speed



Ti-Gold



Ti-Black



Silver/Silver



Dht Treatment



Mud And Water
Shed Off



Inner Chamfered
Plate



Outer Chamfered
Outer Plates



Light Weight
Design



Hollow Pins



Super Length
Inner Chamfer

DECA-101 (UL)

Sigma⁺

Connector Included

Compatibility:

10-Speed,

1/2" x 5/64"

10 Speed



Ti-Gold



Ti-Black



Silver/Silver



Dht Treatment



Mud And Water
Shed Off



Inner Chamfered
Plate



Outer Chamfered
Outer Plates



Light Weight
Design



Super Length
Inner Chamfer



Hollow Pins



NOVE-91 (UL)

Sigma⁺

Connector Included

Compatibility:

9-Speed,

1/2" x 5/64"

9 Speed



Ti-Gold



Silver/Silver



Dht Treatment



Mud And Water
Shed Off



Inner Chamfered
Plate



Outer Chamfered
Outer Plates



Light Weight
Design



Super Length
Inner Chamfer



Inclined Bridge



Hollow Pins



12S-8S OFFROAD BIKE CHAIN

Chains are made for all systems, all demanding riders, and all toughest environment. With DHT (Diamond Hard Treatment), The durability of the chain would last longer than other chains.



MORE INFO

RECOMMENDED FOR ALL 12-8 SPEED DRIVETRAIN SYSTEM.

TOLV - 121

Sigma⁺

Connector Included

Compatibility:

12-Speed,

1/2" x 5/64"

12 Speed



Galaxy



Ti-Gold



Ti-Black



Gst-500



Silver/Silver



Green



Purple Red



Silver/Black



Dht Treatment



Inner Chamfered Plate



Outer Chamfered Outer Plates



Super Length Inner Chamfer



Galaxy Series



Sub Punched Pin

ONZE - 111

Sigma⁺

Connector Included

Compatibility:

11-Speed,

1/2" x 5/64"



Galaxy



Ti-Gold



Ti-Black



Gst-500



Silver/Silver



Green



Purple Red



Silver/Black



Black/Black



Dht Treatment



Inner Chamfered Plate



Outer Chamfered Outer Plates



Super Length Inner Chamfer



Sub Punched Pin



DECA - 101

Sigma⁺

Connector Included

Compatibility:

10-Speed,
1/2" x 5/64"



Galaxy



Ti-Gold



Ti-Black



Gst-500



Silver/Silver



Green



Purple Red



Silver/Black



Dht Treatment



Inner Chamfered
Plate



Outer Chamfered
Outer Plates



Super Length
Inner Chamfer



Sub Punched
Pin

NOVE - 91

Sigma⁺

Connector Included

Compatibility:

9-Speed,
1/2" x 5/64"



Ti-Gold



Ti-Black



Gst-500



Silver/Silver



Silver/Black



Dht Treatment



Inner Chamfered
Plate



Outer Chamfered
Outer Plates



Inclined Bridge



Sub Punched
Pin

TB - 90

Sigma⁺

Connector Included

Compatibility:

9-Speed,

1/2" x 5/64"



Gst-500



Silver/Silver



Silver/Black



Black/Black



Super Length
Inner Chamfer



Deep Dish Chamfered
& Bulged Outer Plates



Sub Punched
Pin

OCTO

Sigma⁺

Connector Included

Compatibility:

8/7-Speed,

1/2" x 3/32"



Gst-500



Silver/Silver



Silver/Black



Inclined Bridge



Inner Chamfered
Plate



Super Length
Inner Chamfer



Sub Punched
Pin

TB - 600

Sigma⁺

Connector Included

Compatibility:

8/7-Speed,
1/2" x 3/32"



Gst-500



Silver/Silver



Silver/Black



Black/Black



Inner Chamfered
Plate



Super Length
Inner Chamfer



Straight Bridge



Sub Punched
Pin

TB - 65

Sigma⁺

Connector Included

Compatibility:

8/7-Speed,
1/2" x 3/32"



Gst-500



Black/Black



Inner Chamfered
Plate



Super Length
Inner Chamfer



Straight Bridge

TB - 50

Sigma Pro
Connector Included
Compatibility:
7/6-Speed,
1/2" x 3/32"
Duel-index
system



Gst-50



Silver/Black



Black/Black



Inner Chamfered
Plate



Super Length
Inner Chamfer



Straight Bridge

6-7 Speed

TB - 15

Sigma Pro
Connector Included
Compatibility:
7/6-Speed,
1/2" x 3/32"
Duel-index
system



Silver/Black



Black/Black



Inner Chamfered
Plate



Super Length
Inner Chamfer



Straight Bridge

6-7 Speed

1 SPEED INTERNAL GEAR HUB

This special Half-link chain is recommended for electric bikes and cycles fitted with internal gear hub. The plates have an asymmetrical design to put the chain closer to the gear sprocket. It is not only uniquely attractive but light weight and the short plate design means it is much easier to find the correct transmission length compared to standard chains.

SUPER SINGLE-a

Sigma Pro
Connector Included

Compatibility:

1/2-Speed,
1/2" x 3/32"

1 Speed



Gst-500



Silver/Black



Color Option



Light Weight Design



Hollow Pins



Half-Link



Asymmetric Shape In Waist



TAIWAN
EXCELLENCE
201



EUROBIKE
AWARD 2010



iF
DESIGN
AWARD
2010

408 H

Sigma Pro

Connector Included

Compatibility:

1-Speed,

1/2" x 3/32"

1 Speed



Gst-500



Silver/Silver



Black/Black



Color Option



High Tension
Strength Over 1,020 Kgf

410 H

Sigma Pro

Connector Included

Compatibility:

1-Speed,

1/2" x 1/8"

1 Speed



Gst-500



Silver/Silver



Black/Black



Color Option



High Tension
Strength Over 1,020 Kgf

1 SPEED, FIXIE AND EXERCISE BIKE









TAYA ensures maximum quality control in roller production enhancing their anti-wear properties in extreme usage conditions, which greatly extends chain life. Chamfers on both the inner and outer plates make the chain noiseless.



TB - 910

Sigma Pro
Connector Included
Compatibility:
1-Speed,
1/2" x 1/8"

1 Speed

	Gst-500		High Tension Strength Over 1,020 Kgf
	Silver/Silver		Inner Chamfered Plate
	Silver/Black		Outer Chamfered Outer Plates
			Enlarged Outer Plates
			Sub Punched Pin

TB - 980

Sigma Pro

Connector Included

Compatibility:

1-Speed,

1/2" x 3/32"



Gst-500



Silver/Silver



Silver/Black



High Tension
Strength Over 1,020 Kgf



Inner Chamfered
Plate



Outer Chamfered
Outer Plates



Enlarged Outer
Plates



Sub Punched
Pin

SPRING CLIP CONNECTOR

Compatible with all
1/2" x 1/8" single
speed chains



Silver/Black

E-BIKE PEDELECS (MID MOTOR DRIVE)

MODEL	e TOLV-121	e ONZE-111	e DECA-101	e NOVE-91	e OCTO-DH	eTB-910 DH
FINISH	GST, S/S	GST, S/S	GST, S/S	GST, S/S	GST, S/S	GST, S/S
12-SPEED	●					
11-SPEED		●				
10-SPEED		●	●			
9-SPEED				●		
8-SPEED					●	
IGH - 3/32" GEAR					●	
IGH - 1/8" GEAR						●

12 SPEED

MODEL	TOLV-121
FINISH	Galaxy series, Ti-B/G, Ti-B, Ti-G, GST, S/S
COMPARE WITH	EAGLE®-XX1 / X01 / GX / NX / SX, RED® / FORCE®, M9100 / M8100 / M7100, Campy 12S chain
EAGLE AXS® series (XX1 / X01 / GX / NX / SX / XG)	●
RED eTAP® AXS	●
Force eTAP® AXS	●
Rival eTAP AXS	●
RED®	●
DURA-ACE*	●
XTR*	●
DEORE*	●
XT*	●
SLX*	●
DEORE*	●
SUPER RECORD™	●
RECORD™	●
CHORUS™	●
105 di2	●
GRX di2	●

Finish:

G = Gold

S = Silver

B = Black

GST-TG = Eco-Friendly Anti-Rust
Treatment [GST500(TG)]

* Registered Trademark of Shimano Inc.

™ Registered Trademark of Campagnolo Srl.

® Registered Trademark of SRAM LLC.

11 SPEED

MODEL	EL-ONZE 117	ONZE-111 (UL)	ONZE-111
FINISH	Galaxy series, Ti-B/G, Ti-B, Ti-G, GST, S/S, UP-BEAT series	Ti-B, Ti-G, GST, S/S	Galaxy series, Ti-B/G, Ti-B, Ti-G, GST, S/S, S/B
COMPARE WITH	HG-701 / 601 / 6800 / PC-1110	HG-901 / 9000, RED22 / PC-1170 / 1130®, Campy 11S chain	HG-701 / 601 / 6800, PC-1110 / LG-500
SRAM Rival® series			●
SRAM Force® series	●	●	
APEX® series			●
LINKGLIDE*			●
HYPERGLIDE*			●
XTR*	●	●	●
DEORE*	●	●	●
105*	●	●	●
GRX*			●
CHORUS™			●
POTENZA™ / CENTAUR™	●	●	

10 SPEED

MODEL	DECA-101 (UL)	DECA-101
FINISH	Ti-B, Ti-G, GST-TG, S/S	Galaxy series, Ti-B/G, Ti-B, Ti-G, GST, S/S, S/B
COMPARE WITH	7901 / 6701 / 5701 / 4601 / PC-1091R / 1071	7801 / 6600 / 5600 / 4601 / HG94 / HG74 / M981 / PC-1051 / 1031 / LG-500
APEX® series	●	●
TIAGRA*	●	●
LINKGLIDE*		●
DEORE*		●
SAINT*		●
ZEE*		●
TIAGRA*		●
GRX		●

9 SPEED

MODEL	NOVE-91 (UL)	NOVE-91	TB-90
FINISH	Ti-G, GST, S/S	Ti-G, GST, S/S, S/B	GST, S/S, S/B, B/B
COMPARE WITH	PC-991 HP	7701 / HG93 / 73 / 53, PC-991 / 971 / 951	7701 / HG93 / 73 / 53, PC-991 / 971 / 951
SORA®	●	●	●
ALIVIO®		●	●
ACERA*		●	●
ALTUS*		●	●
ALFINE*		●	●

8/7 SPEED

MODEL	OCTO-DH	OCTO	TB-600	TB-65
FINISH	GST, S/S	GST, S/S, S/B, B/B	GST, S/S, S/B, B/B	S/S, S/B, B/B
COMPARE WITH	HG91 / 71 / 50 / PC-890 / 870 / 850 / 830			
ACERA/ALTUS*		●	●	●
ALTUS*		●	●	●
CLARIS*		●	●	●
TOURNEY TX*				●

7/6/5 SPEED

MODEL	TB-50	TB-15 (DIRECTIONAL)	TB-408	EL-408
FINISH	GST, S/B, B/B	S/S, B/B	G/G, G/B, S/S, S/B, B/B	S/S, B/B
COMPARE WITH	HG-40 / UG51	HG-40 / UG51	PC10	
TOURNEY® series	●	●	●	●
INDEX	●	●	●	●
NON-INDEX			●	●

SINGLE SPEED (INCLUDES INTERNAL-GEAR HUB/FIXED GEAR & BMX)

MODEL	SUPER SINGLE-a	TB-980	408H	TB-910	410H	410B
FINISH	GST, S/S	S/S, S/B	GST, S/S, B/B	S/S, S/B	GST, S/S, B/B	S/S, B/B
COMPARE WITH					NX10	PC-1
EXERCISE BIKE 3/32" GEAR	●	●	●			
EXERCISE BIKE 1/8" GEAR				●	●	●
BMX/FIXED GEAR 3/32" GEAR		●	●			
BMX/FIXED GEAR/ COASTER 1/8" GEAR				●	●	●
IGH - 3/32" GEAR	●		●			
IGH - 1/8" GEAR					●	●
CITY/CHILD BIKE W/1/8" GEAR						●

Finish:

G = Gold

S = Silver

B = Black

GST-TG = Eco-Friendly Anti-Rust
Treatment [GST500(TG)]

* Registered Trademark of Shimano Inc.

™ Registered Trademark of Campagnolo Srl.

® Registered Trademark of SRAM LLC.

E-BIKE SERIES PKG



e TOLV-121



e DECA-101



e OCTO-DH



e ONZE-111



e NOVE-91



e TB-910-DH

FINISH: GST-500 Silver/Silver

MY22 NEW ARRIVAL PKG



30 METER SMALL ROLL SERIES

MY22 NEW ARRIVAL PKG



SIGMA+ CONNECTOR CARD



PANEL BOX SERIES 10 pcs

12S-8S BIKE CHAIN



12 Speed

11 Speed

10 Speed

9 Speed

8 Speed

1 Speed



SIMPLIFY
your ride.



2024 *catalogue*

www.tayachain.com

No.30, Zhong-Shan Rd., Ren-De Dist., Tainan City 71752,
Taiwan (R.O.C.)
台南市仁德區中山路30號